

ABOUT US

We are one of a large network museums located around Australia that operates as part of the Australian Army History Unit.

At AAMME, our goal is to preserve, display and to educate about the significant history and many contributions of the Royal Australian Engineer Corps and the Royal Australian Survey Corps.

WHO ARE SAPPERS?

'Sapper', 'sappe' or 'sapeur' were terms used by the French military to refer to soldiers and their digging of trenches to besiege fortress walls in the 17th century.

'Sapper' is now used as a general term to refer to all members of the Royal Australian Engineer Corps. It is also the equivalent rank title to 'Private' for soldiers in the Corps.

First in and last out in any operation, sappers must often operate with limited supplies. Throughout the museum, you will see examples of their renowned ingenuity (known as 'sappernuity') used to solve the many engineering problems they have faced over the last 120 years.

VISITING THE MUSEUM

DEFENCE MEMBERS
MONDAY & FRIDAY 1000—1500

GENERAL PUBLIC
TUESDAY & THURSDAY 1000-1500
FIRST SATURDAY OF EACH MONTH 1000-1500

PUBLIC ACCESS

All members of the general public must contact the AAMME to book a visit 48 hours in advance. Group bookings require at least 1 week notice. Once confirmed, visitors are required to meet a staff member at the Holsworthy Pass Office to be escorted to the Museum. A physical copy of current, government issued ID is required for all visitors over the age of 16.

CONTACT US

Phone: (02) 8108 5054
Email: aamme.mailbox@defence.gov.au

Army Museum of Military Engineering
Building G220
Alec Campbell Drive
Holsworthy NSW 2173

MAP & GUIDE

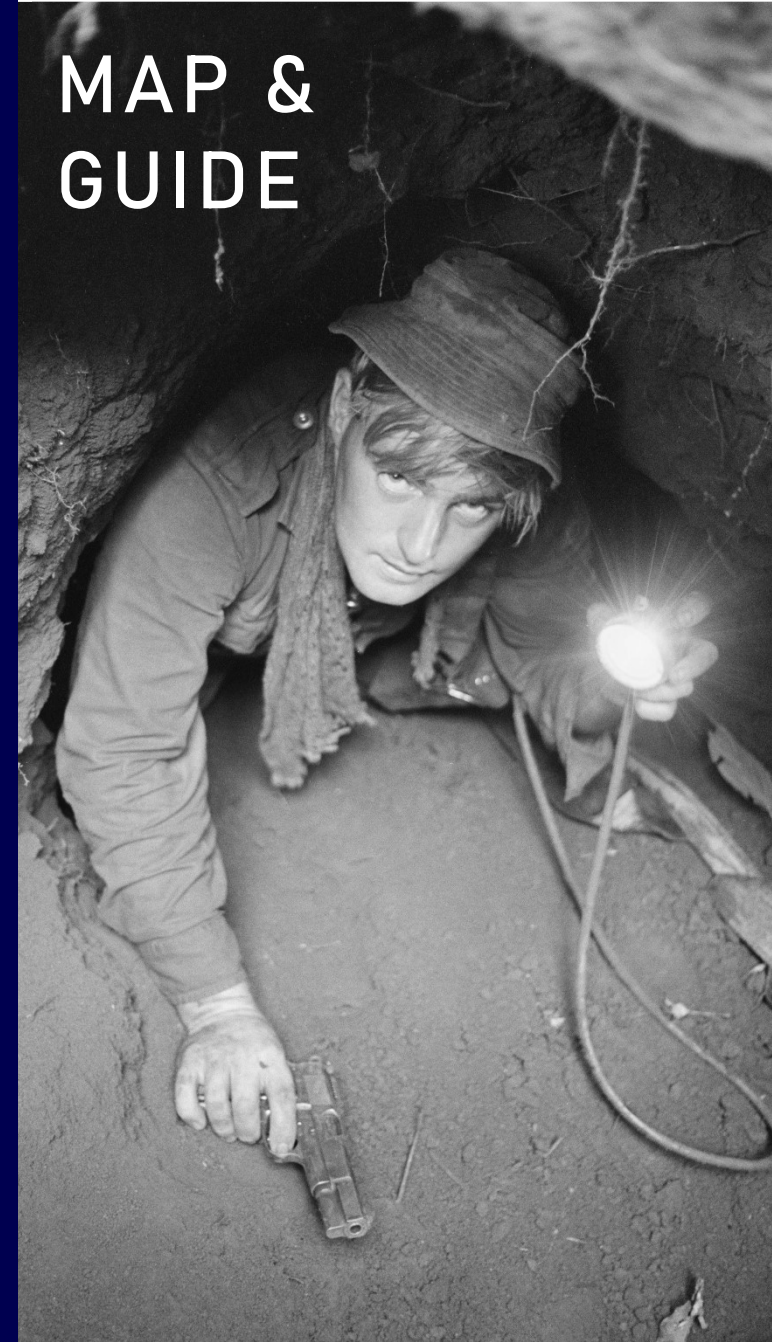

1
Level 1

G
Ground Floor

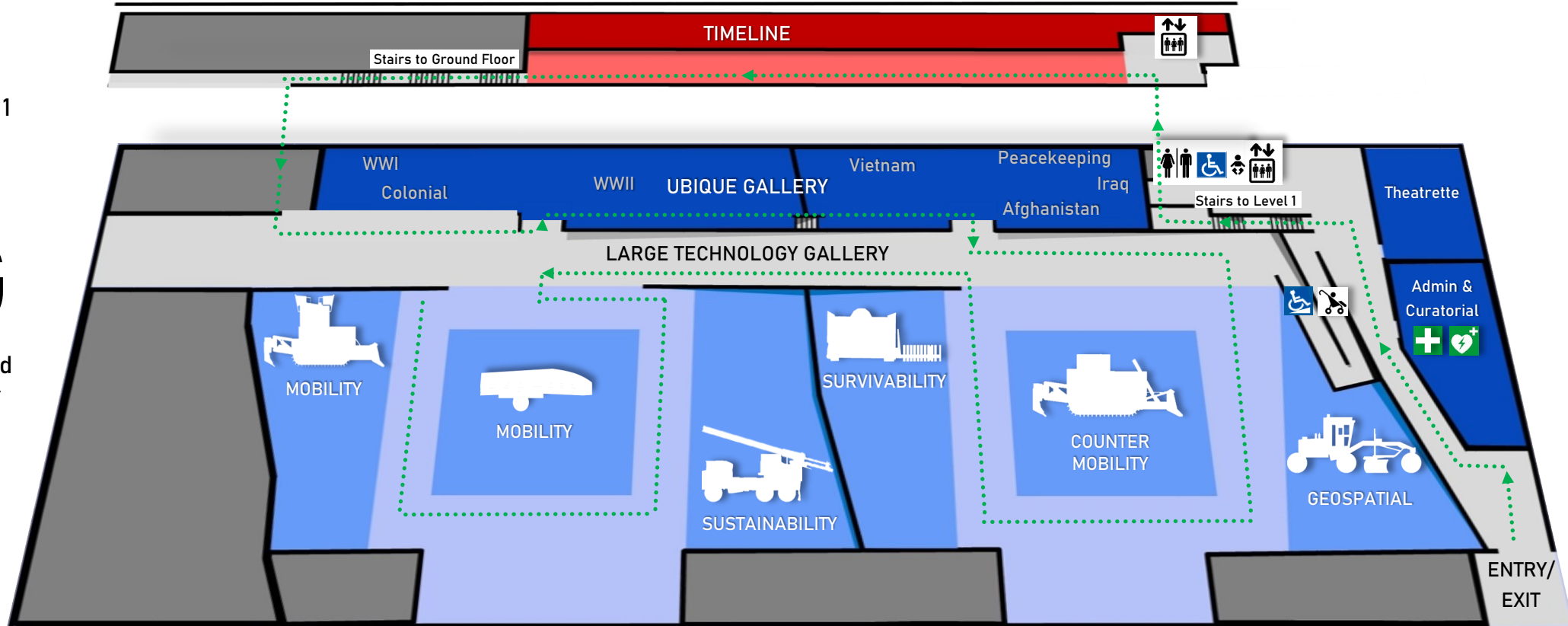

GUIDE

To get the most out of your visit, we recommend the following order:

1. TIMELINE

Take the stairs or lift to level 1. This section gives a visual, chronological overview of the history of the Royal Australian Engineer Corps and Royal Australian Survey Corps.

2. UBIQUE GALLERY

Enter through the double doors on the ground floor. This gallery features the achievements of the Royal Australian Engineers from the colonial period to present day. *Ubique* is the Royal Australian Engineer Corps motto and means “everywhere” in Latin.

3. LARGE TECHNOLOGY GALLERY

Exit the Ubique Gallery and explore our large technology. These pieces are sectioned into areas that represent the responsibilities of the Royal Australian Engineers.

- Recommended route
- First Aid
- Defibrillator
- Ramp
- Stroller access
- Toilets
- Accessible toilet
- Baby changing facilities
- Lift